

FIG 001

TX39H

# BUCKET

P1

Year / Month

2020 / 03

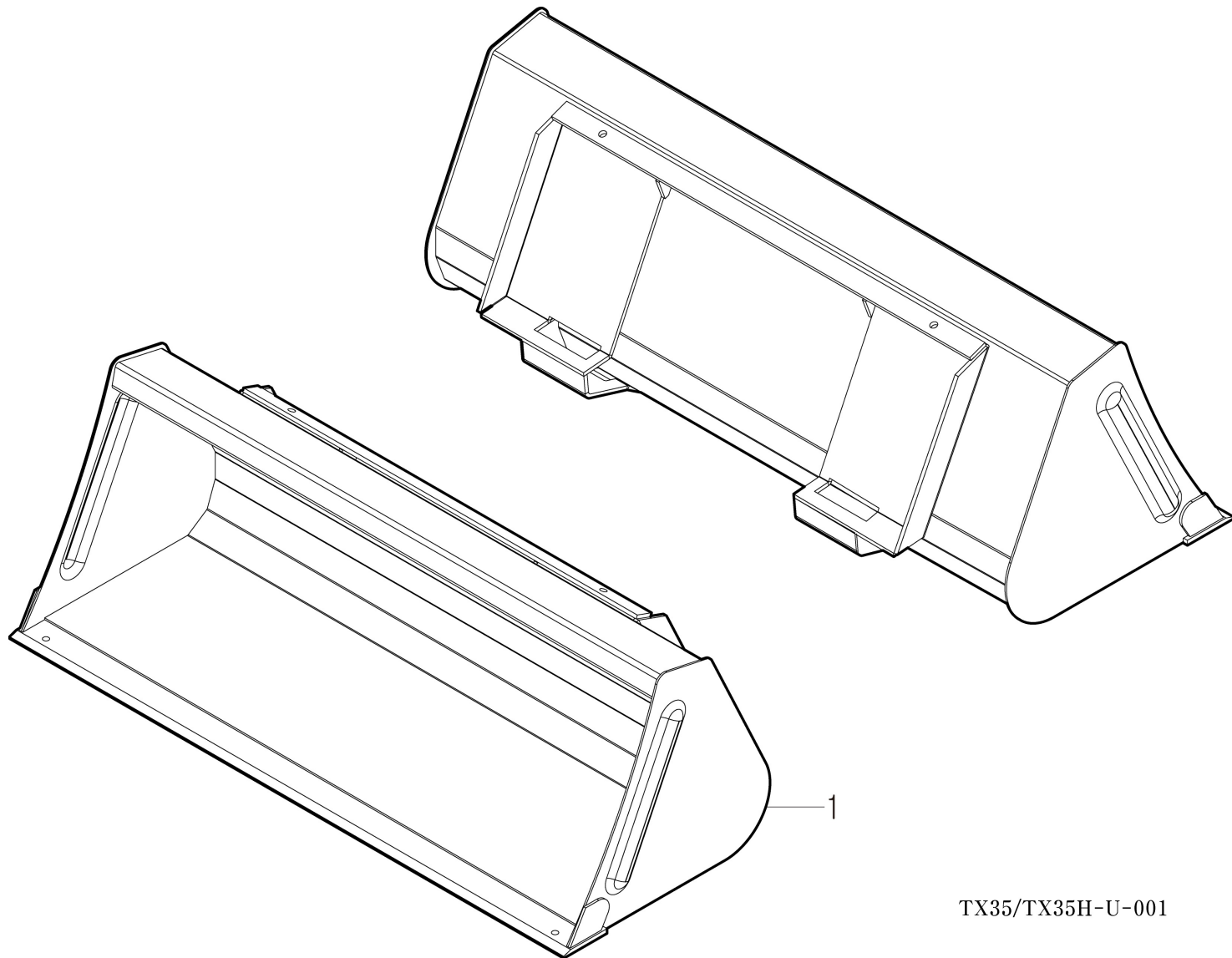
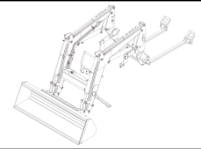

TX35/TX35H-U-001



FIG 002

TX39H

# QUICK ATTACHMENT ASS'Y

P1

Year / Month

2020 / 03

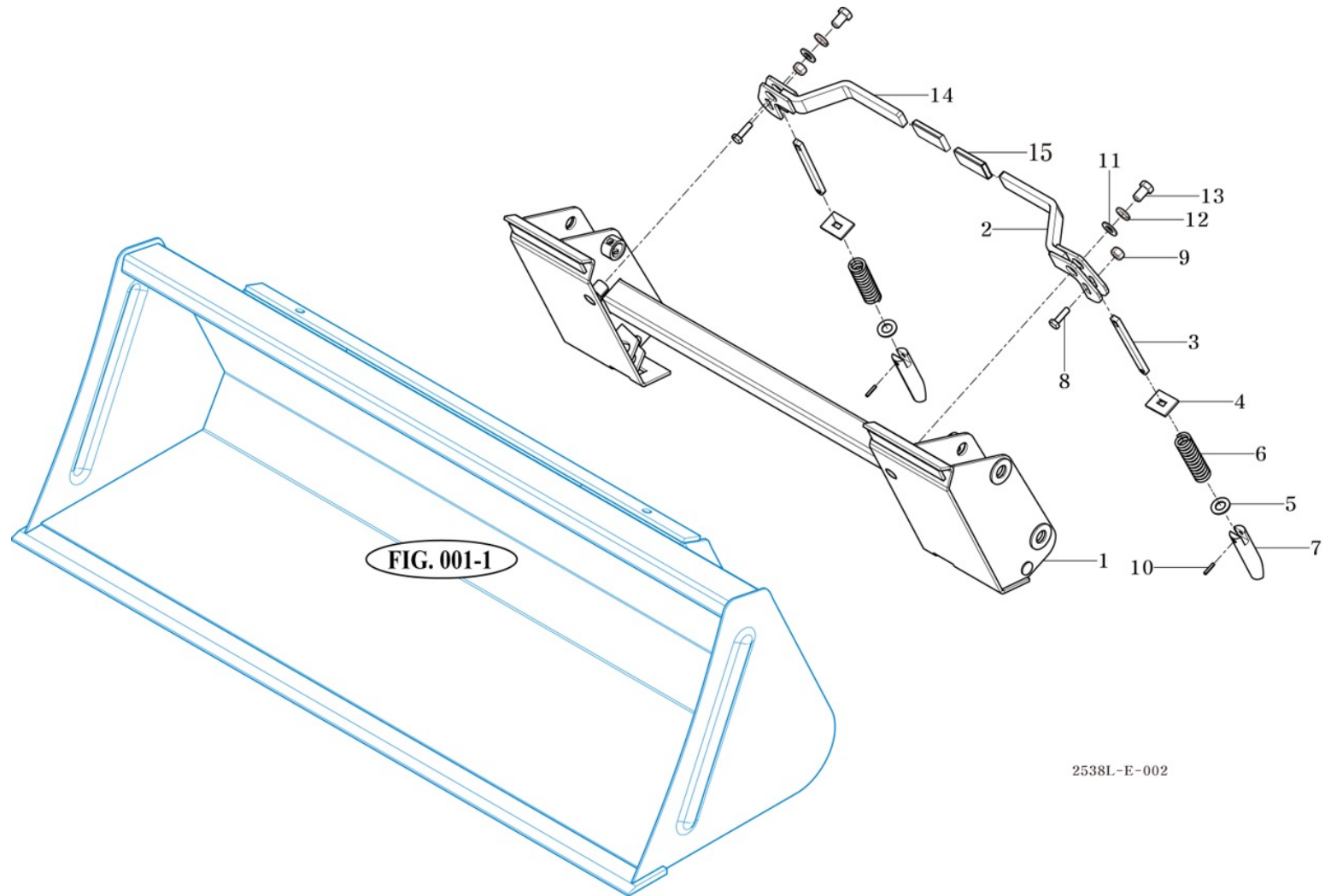
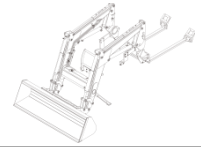

FIG. 001-1

2538L-E-002



FIG 003

TX39H

# MOUNTING FRAME ASS'Y

P1

Year / Month

2020 / 03

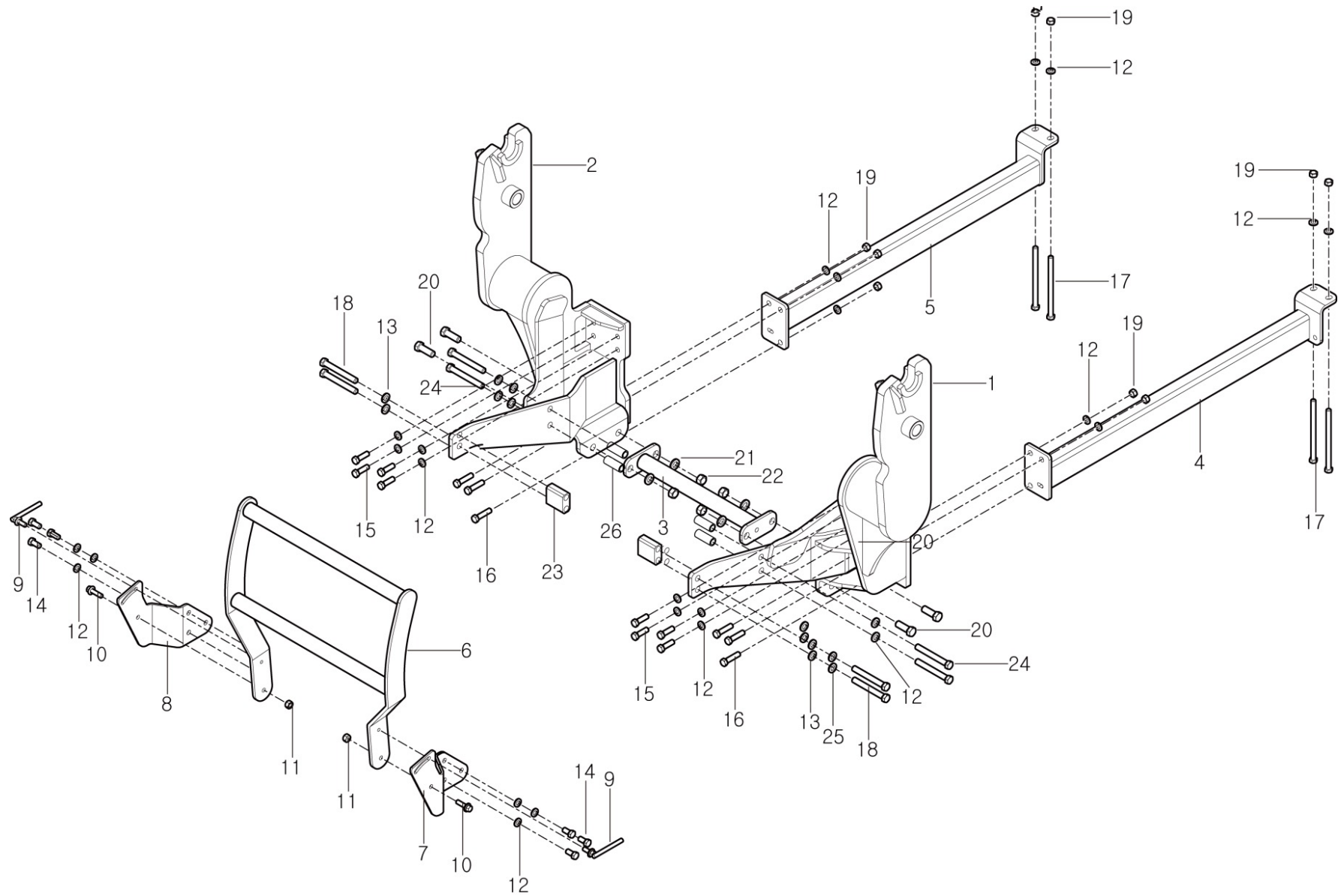
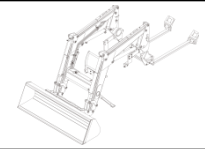



FIG 003		MOUNTING FRAME ASSEMBLY			P1	Year/Month 2020/03	
KEY NO.	PART NO.	DESCRIPTION	SPEC.	QTY.	EFFECTIVE DATE	REMARKS	
003	001	85211001009GB	MOUNTING FRAME COMP LH		1		
003	002	85211002009GB	MOUNTING FRAME COMP RH		1		
003	003	85201003001GB	CROSS BAR COMP		1		
003	004	85211004002GB	REAR FRAME COMP LH		1		
003	005	85211005002GB	REAR FRAME COMP RH		1		
003	006	85211006100GB	GRILL GUARD COMP		1		
003	007	85411006011GB	BRACKET LH	6.0T	1		
003	008	85411006031GB	BRACKET RH	6.0T	1		
003	009	85401006062	LEVER BOLT		2		
003	010	V2183610035	BOLT , HEX / SP	M10X35	2		
003	011	85402003130	U NUT	M10	2		
003	012	V4011600120	WASHER, SPRING	M12	28		
003	013	V4011600140	WASHER, SPRING	M14	4		
003	014	V2014612025	BOLT , HEX	M12X25	6		
003	015	V2014612040	BOLT , HEX	M12X40	8		
003	016	V2014612050	BOLT , HEX	M12X50	6		
003	017	V2014612180	BOLT , HEX	M12X180	4		
003	018	V2014614090	BOLT , HEX	M14X90	4		
003	019	V3043600120	NUT, HEX/2	M12	10		
003	020	V2014616045	BOLT , HEX	M16X45	4		
003	021	V4011600160	WASHER, SPRING	M16	4		
003	022	V3044600160	NUT, HEX/2	M16	4		
003	023	85211001081GB	SPACER		2		
003	024	V2014612180	BOLT , HEX	M12X110	4		
003	025	V4111600120	WASHER, PLAIN	M12	4		
003	026	85211007010	SPACE , MOUNT		4		

FIG 004

TX39H

# BOOM ASS'Y

P1

Year / Month

2020 / 03

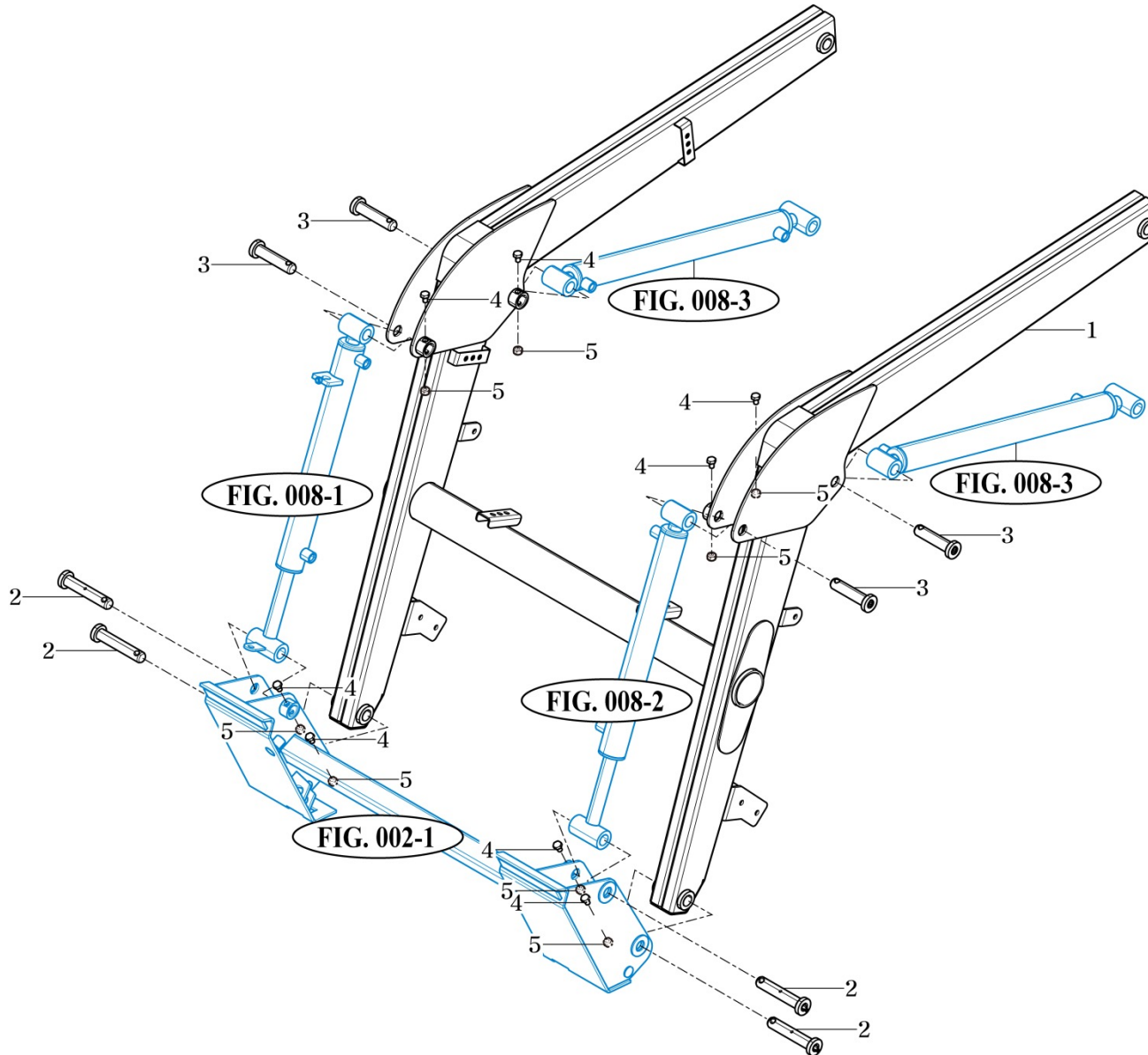
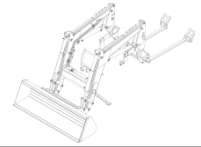





FIG 005

TX39H

# POST ASSEMBLY

P1

Year / Month

2020 / 03

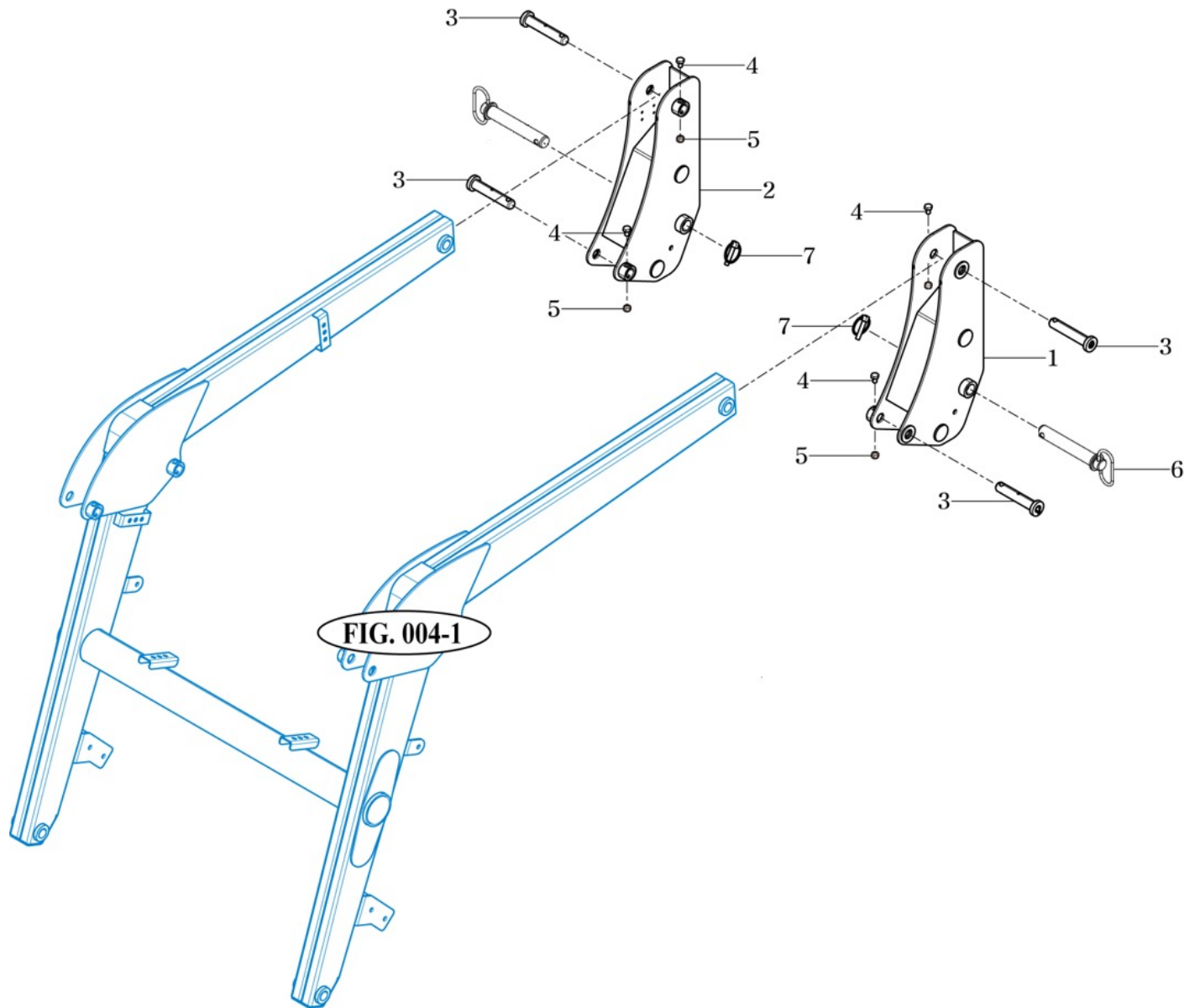
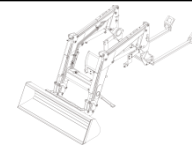



FIG 006

TX39H

# STAND & SAFETY BAR

P1

Year / Month

2020 / 03

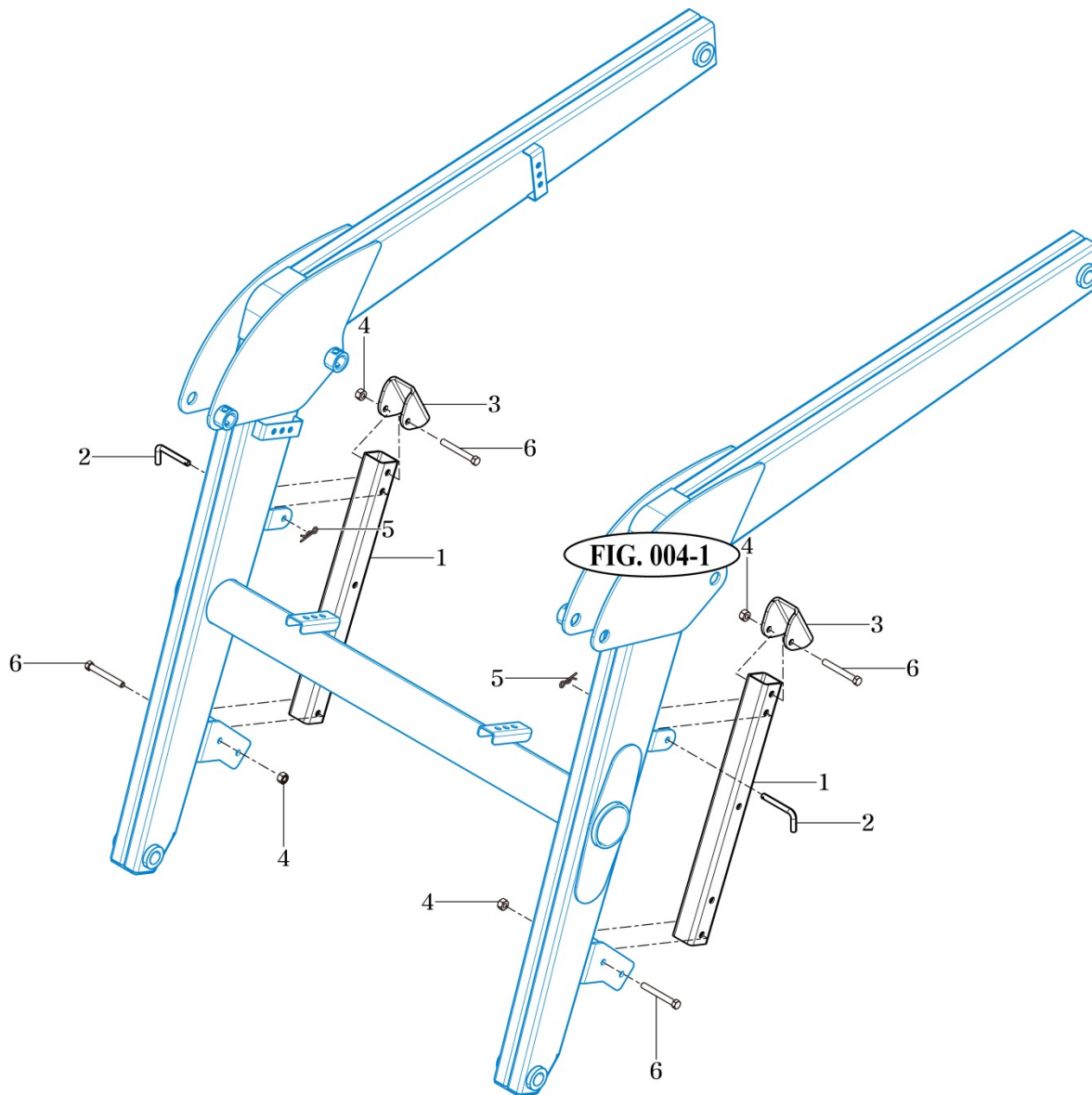
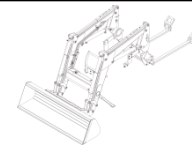



FIG 007

TX39H

# LOADER VALVE

P1

Year / Month

2020 / 03

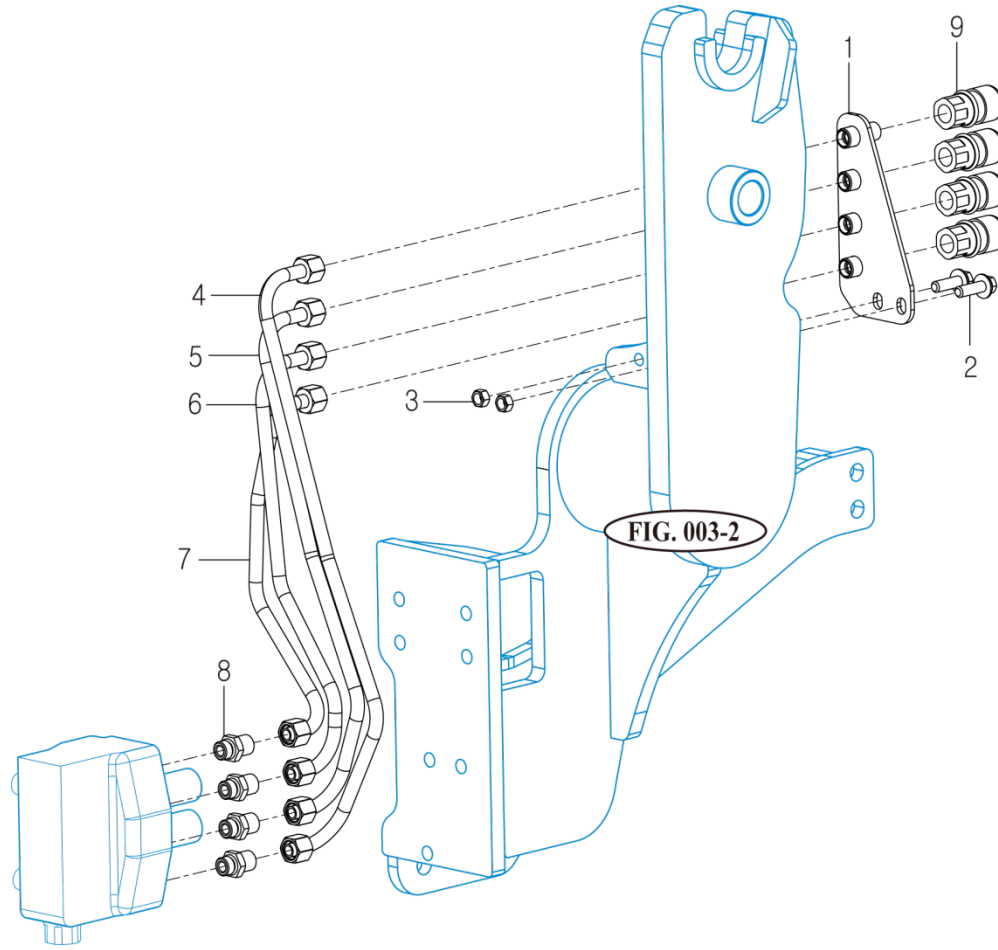
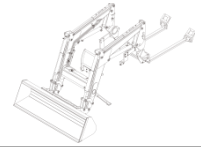



FIG 008

TX39H

# HYDRAULIC PIPING ASSEMBLY

P1

Year / Month

2020 / 03

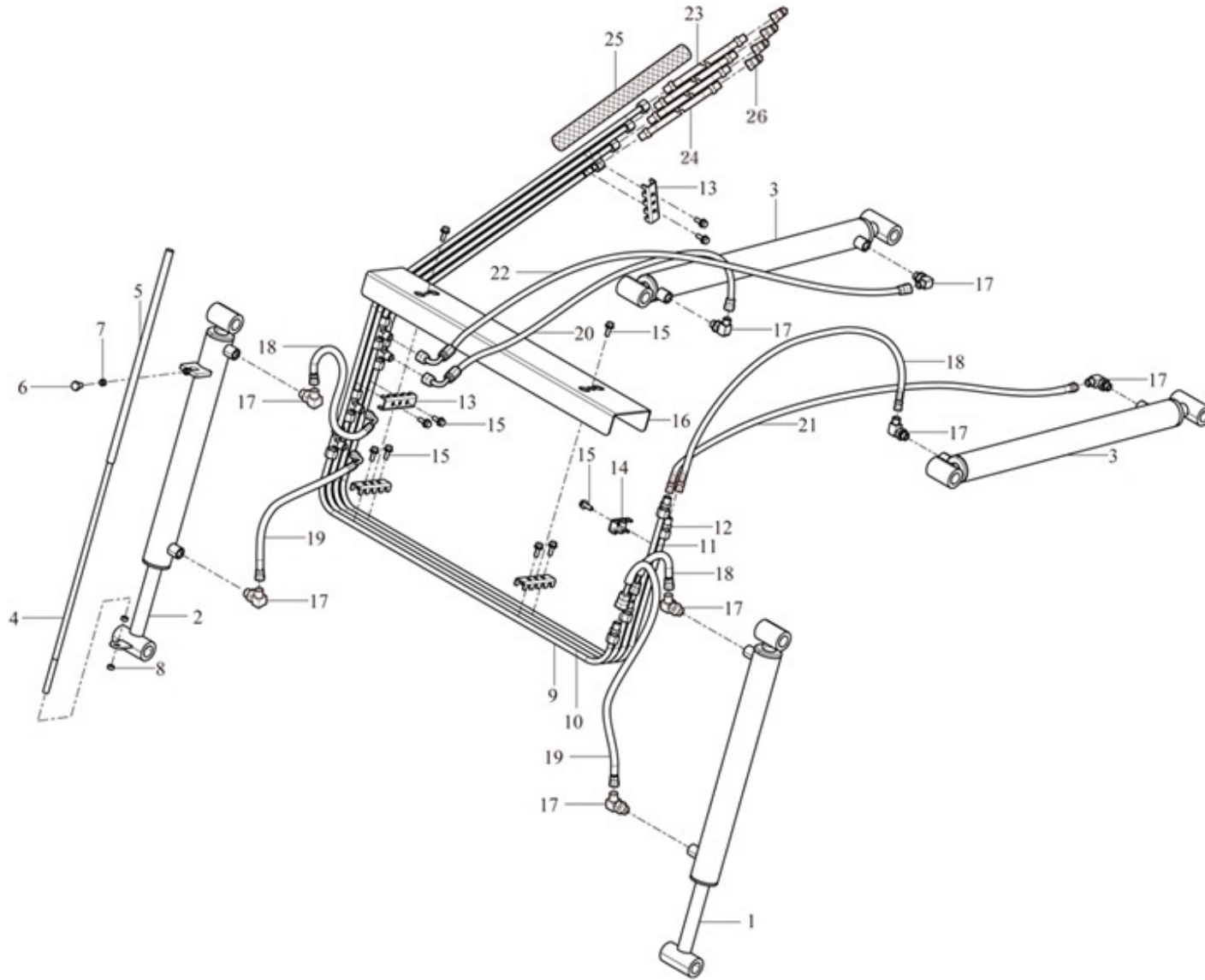
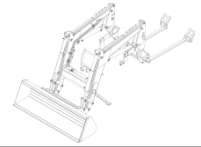



FIG 008		HYDRAULIC PIPING ASSEMBLY			P1	Year/Month 2020/03	
KEY NO.	PART NO.	DESCRIPSTION	SPEC.	QTY.	EFFECTIVE DATE	REMARKS	
008 001	85813001000GB	CYLINDER ASSY. BUCKET LH		1			
008 002	85813002000GB	CYLINDER ASSY. BUCKET RH		1			
008 003	85703003000GB	CYLINDER ASSY. BOOM		2			
008 004	85903000111	STUD. BUCKET	D12	1			
008 005	86603000301	GUIDE. BUCKET	D15.9X1.6T	1			
008 006	V2013610030	BOLT. HEX	M10X30	1			
008 007	V3043600100	NUT. HEX	M10	1			
008 008	V3043600120	NUT. HEX	M12	2			
008 009	85703009001	PIPE ASSY. BUCKET RALLBACK		1	~2016.07		
008 009	85213009000	PIPE ASSY. BUCKET RALLBACK		1	2016.08~		
008 010	85703008001	PIPE ASSY. BUCKET DUMP		1	~2016.07		
008 010	85213008000	PIPE ASSY. BUCKET DUMP		1	2016.08~		
008 011	85703007000	PIPE ASSY. BOOM DOWN		1	~2016.07		
008 011	85213007000	PIPE ASSY. BOOM DOWN		1	2016.08~		
008 012	85703006000	PIPE ASSY. BOOM UP		1	~2016.07		
008 012	85213006000	PIPE ASSY. BOOM UP		1	2016.08~		
008 013	86502000060	BRACKET B	3.2T	4			
008 014	86502000070	BRACKET C	3.2T	1			
008 015	V2183608040	BOLT. HEX	M8X40	11			
008 016	86803009010	COVER. PIPE		1			
008 017	36313530021	ADAPTOR		8			
008 018	86003004020	HOSE ASSY. 450 90° HYD	PF3/8	3			
008 019	86503000360	HOSE ASSY. 510 90° HYD	PF3/8	2			
008 020	86403000370	HOSE ASSY. 620 90° HYD	PF3/8	1			
008 021	85403004060	HOSE ASSY. 900	PF3/8	1			
008 022	86003004051	HOSE ASSY. 980 90° HYD	PF3/8	1			
008 023	85413009910	HYD. HOSE 1000	PF3/8	2			
008 024	85413009920	HYD. HOSE 1100	PF3/8	2			
008 025	V7740010601	NIPPLE	PT3/8	4			
008 026	81203000510	HOSE COVER	L=700	1			



FIG 009

TX39H

# DECAL

P1

Year / Month

2020 / 03

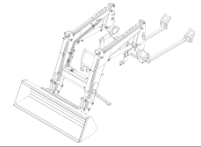

## TX39H

2

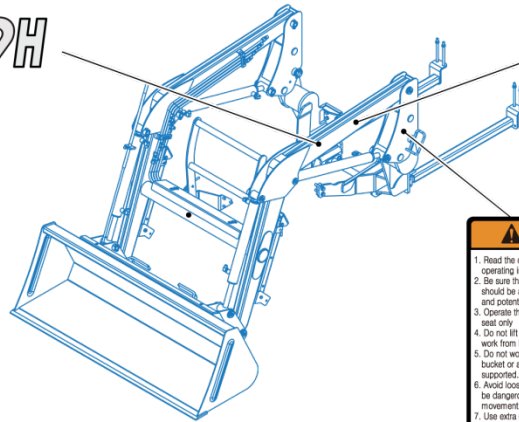

## TMI

1

**WARNING**

1. Read the operator's manual for complete operating instructions and safety.
2. Be sure that anyone operating the loader should be aware of safe operating practices and potential hazard.
3. Operate the loader from the operator's seat only.
4. Do not lift or carry anyone on the loader or work from bucket or attachment.
5. Do not work under the raised loader, bucket or attachment if it is not securely supported.
6. Avoid loose fill, rocks and holes: these can be dangerous for loader operation or movement.
7. Use extra caution when working on steep hills.
8. Avoid overhead power lines or obstacles when loader is raised.

8540-500-005-1

**DANGER**

**INTALL SAFETY PROP BEFORE WORKING UNDER RAISED STRUCTURE**

8540-500-006-0

8

**WARNING**

Cancer and Reproductive Harm

[www.P65Warnings.ca.gov](http://www.P65Warnings.ca.gov)

344910-0200

9

**WARNING**

NEVER USE FRONT END LOADER FOR TOWING OPERATIONS.

8540-500-009-1

7

## TMI

1

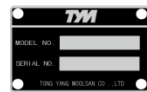

3

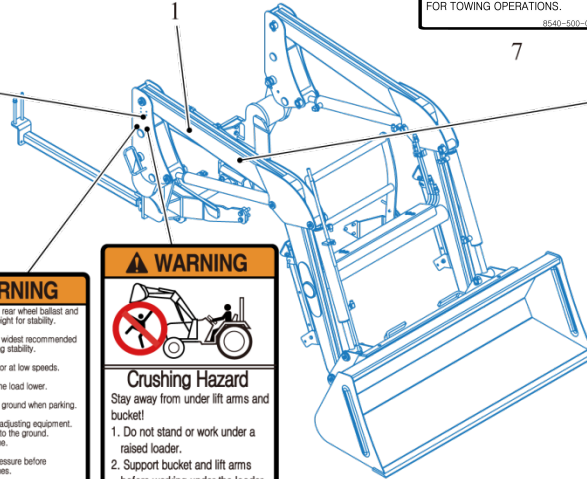

## TX39H

2

**WARNING**

1. Add recommended rear wheel ballast and /or rear counter-weight for stability.
2. Move wheels to the widest recommended setting for increasing stability.
3. Move and turn tractor at low speeds.
4. In transport, carry the load lower.
5. Lower loader to the ground when parking.
6. Before servicing or adjusting equipment:
  - Lower the loader to the ground.
  - Shut off the engine.
7. Relieve hydraulic pressure before disconnecting oil lines.
8. Observe safety recommendation in Loader Operation Manual.

8540-500-004-1

4

**WARNING**

**Crushing Hazard**  
Stay away from under lift arms and bucket!

1. Do not stand or work under a raised loader.
2. Support bucket and lift arms before working under the loader.
3. Lower the loader to the ground before leaving seat.

8540-500-004-1

5

